

DESCRIÇÃO	UNIT	GLG-1680
<b>CURSOS</b>		
X-axis	mm	1600
Y-axis	mm	800
Z-axis	mm	730
Spindle nose to table surface	mm	100-830
Spindle center to column surface	mm	875 (34.4)
X.Y.Z axis Ball screws dia	mm	50 x pitch12
<b>MESA</b>		
Table size	mm	1700*800
Working Area	mm	1600*800
Tee Slots (CD x W x No.)	mm	CD 100x18x8
Max. Table Load	Kg	2000 (4400)
<b>SPINDLE</b>		
Spindle taper		BT50 / CAT50
Spindle speed-standard access	rpm	-
Belt drive	rpm	8,000(std) 10,000(opt) -Belt drive
Direct Drive	rpm	opt.8,000/10,000/12,000 -Direct drive
Built-in Drive	rpm	opt. 12,000/20,000 -Built-in
<b>AVANÇOS</b>		
Cutting feedrate	mm/min	1-10,000 Depending on the controller
3-axes slideways		Linear Ball Slide / <b>opt.</b> Linear Roll Slide
Rapid transverse rates(X,Y,Z)	m/min	20,000/20,000/15,000
<b>A.T.C</b>		
Capacity-standard access	pcs	16(Armless)
Capacity-optional access	pcs	std: 24(Disc type) <b>opt:</b> 32/40(Tools)
Tool selection		Bi-directional & min. path
Max. tool diameter x length	mm	Armless:89*250(3.5*9.8) / Arm:80*250
Max. tool weight	Kg	6
Air power required		6 kg/cm <sup>2</sup>
Tool shank		BT50/ISO50 or CAT50
<b>MOTOR</b>		
Spindle drive motor	kw(HP)	std:15kw(20HP) <b>opt.</b> ZF gear box11kw(15HP)
<b>BOLA LINEAR DESLIZANTE</b>		
X,Y,Z axis		45 / 45 / 45
Carriage guide block-per axis		4
Coolant pump	HP	1/2
Power supply		30KVA
Net weight	Kg	12,500

## DIMENSÕES

A	cm	425
B	cm	250
C	cm	210
D	cm	89
E	cm	320 / 330

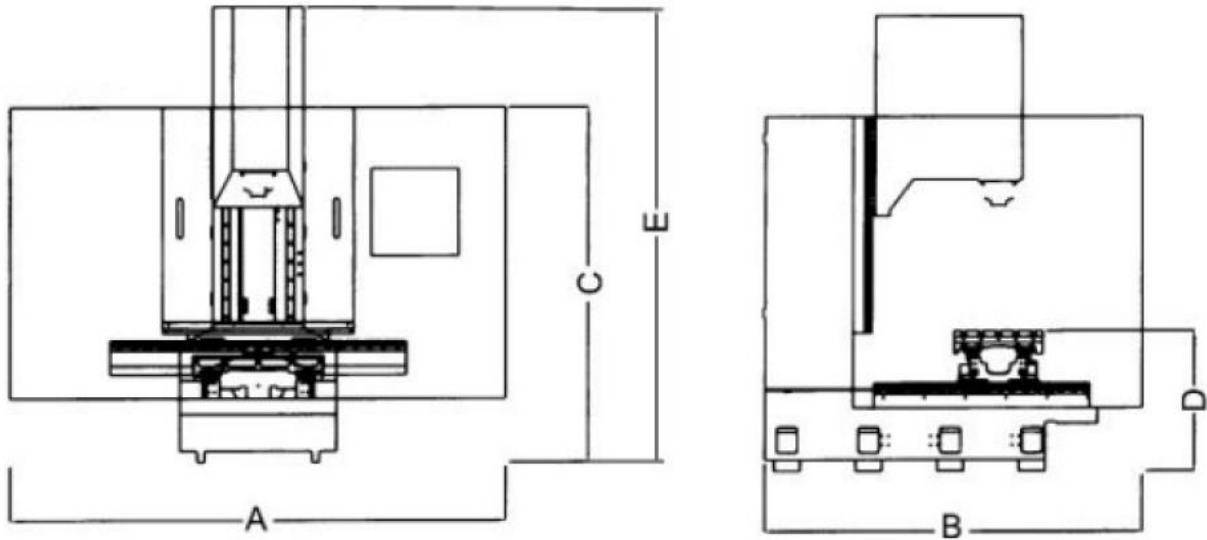

*The best solution, the best partner*